



Description

Levven Quick-Mount wireless switches transmit to controllers to wirelessly turn lights and devices on and off. Use Levven Quick-Mount wireless switches anywhere in your home or business, including detached garages, gatehouses, exterior lights, and storage buildings to control devices without running wire to an installed switch location.

Installation

Levven Quick-Mount wireless switches can be mounted onto any surface: brick, tile, drywall, concrete. Snap up to four CSQW switches together and finish with a screwless snap-on Designer Series cover plate. Additionally, the switch can be kept portable.

Specifications:

Wireless Range	75 m / 250 ft	Operating temp	-25°C to 50°C
Frequency	900 MHz band	Longevity	65+ years at 15 operations day.
Encryption	128-bit	Battery	CR2032 3V lithium manganese dioxide battery
Color	White (W)	Battery life	8+ years
Cover plate	Designer series compact wall plate	Environment	Indoor use only
Visual indicator	LED		

Physical dimensions:

Length	3.5" (89mm)
Width	1.3" (33mm)
Depth	0.5" (12mm)

Pairing:

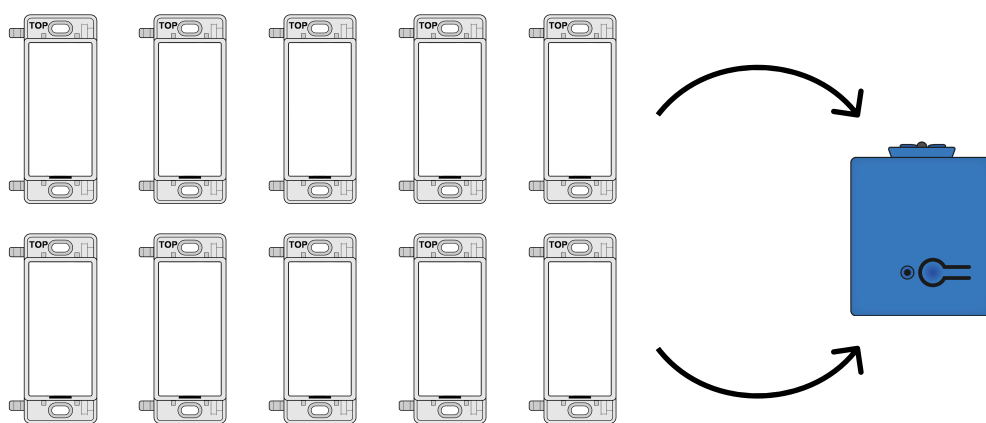

Levven controllers can be paired with up to 10 switches.

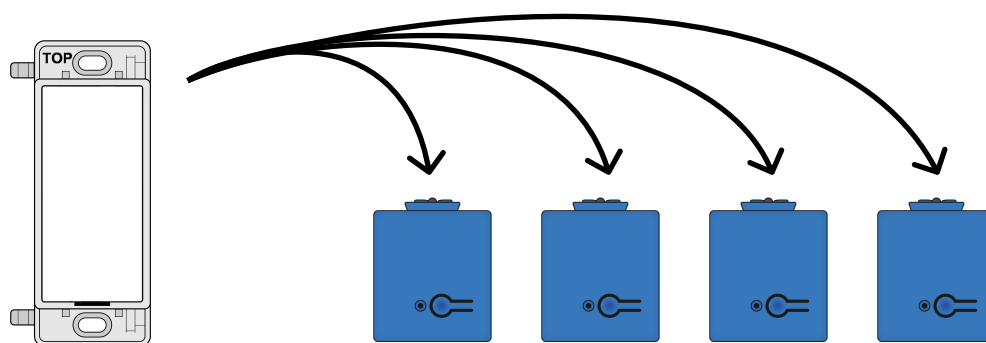

One switch may be paired with as many controllers as are within wireless range.

Certifications for CSQW:

FCC ID: 2ADH9-CSX
IC ID: 12453A-CSX



Manufacturer information:

Levven Electronics Ltd.
9741 - 54 Ave NW
Edmonton, AB, Canada T6E 5J4

Proudly manufactured in 
Telephone: +1 (844)-553-8836
Email: info@levven.com
Website: www.levven.com